

Agenda & Events

Elentra
ENGAGE
2019 NEW YORK CITY
SEPTEMBER 23—24

Martin V. Pusic, MD, PhD, FRCP(C)

A practicing Pediatric Emergency physician, Dr. Pusic also has expertise in human cognition as it pertains to education metrics, health informatics and the longitudinal assessment of clinical skills. These disparate areas of inquiry come together in the development of cognitive simulations for clinical trainees. Dr. Pusic developed computer tutorials for medical students and subsequently carried out multiple randomized trials of the tutorials looking to improve medical student learning in outpatient settings. More recently, he has explored how physicians learn to make diagnoses and decisions. Using radiograph interpretation as a model, and drawing on Signal Detection Theory, Item Response Theory and the principles of Deliberate Practice, he has conducted and collaborated on a series of studies showing that serial practice can be optimized in ways unique to the practice of medicine. The balancing of sensitivity and specificity in making routine decisions, and the inter-practitioner variability in this balance, is a profoundly important theme as medicine looks for ways to use resources wisely while continuing to maintain optimal patient outcomes.

Dr. Pusic's core areas of expertise include educational informatics, student and resident assessment, meta-cognition, and statistical modelling of learning. His most recent research focuses on statistical modelling and prediction of learning trajectories. The research has as its foundation the predictive learning analytics approaches that better educational data systems are just beginning to make possible. Dr. Pusic is a co-investigator on NYU's "Accelerating Change in Medical Education" grant, funded by the American Medical Association and leads a U.S. Dept of Defense Grant entitled "An Adaptive Tutor for Improving Visual Diagnosis".

Dr. Pusic obtained his medical degree from the University of British Columbia, a fellowship in pediatric emergency medicine at McGill, and his PhD in Education from Teachers College at Columbia University. He is a member of the Pediatric Emergency Medicine Sub-Board of the American Board of Pediatrics as well as the Education Science Sub-Committee of the American Heart Association.

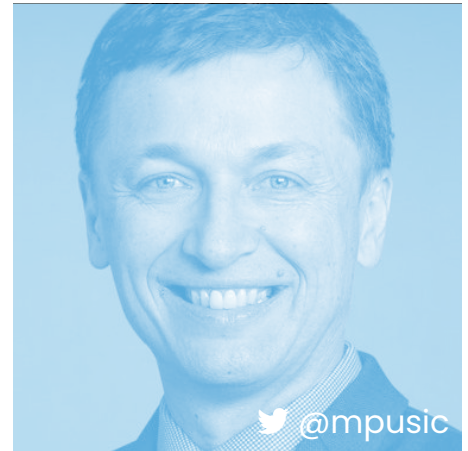

Director, Division of Learning Analytics, Institute for Innovation in Medical Education, NYU School of Medicine.

Associate Professor of Emergency Medicine, Department of Emergency Medicine, NYU School of Medicine.

Dr. Pusic will be giving the keynote closing presentation "Adaptive Learning" at 2:50pm on Tuesday.

Presentations

UI Design: From Idea to Picture

Samuel Hudson Campbell (Core)

A conversation about the role User Interface plays within the larger system of User Experience, and how it fits into the Elentra Core design process, taking the audience from initial requirements to final high resolution prototype.

Enterprise Application Architecture

Eric Green (Core)

Build clean, scalable APIs in Laravel with a layered approach.

How you can help faculty leaders be ready for CBME Implementation

Susan Glover Takahashi (University of Toronto)

How you can help faculty leaders be ready for CBME Implementation.

Scheduling a Longitudinal Integrated Clerkship: A 100-day post-mortem

Sean Girard (Washington State University)

The Elson S. Floyd College of Medicine recently launched a 10-month, 100% 3rd year LIC. We decided to engage in granular clinical scheduling of learners, preceptors, and locations. This will be an overview of our planning and development process as well as a look back at the first 100 days of the clerkship from an operations perspective.

UBC—An Agile Odyssey

Stuart Rolland & Anthony Roggeveen (University of British Columbia)

Odyssey – A long wandering or journey. At UBC we've been on the Agile journey for about 3 years now, you're never done but we think we've garnered some pearls of wisdom along the way. In this talk we'll share some of the pain, successes, pitfalls and surprises to help you get started and move faster on your Agile journey, or just help you decide if Agile is for you.

Enhancing the Clinical Experience: Leveraging the Lottery to Populate Rotation Schedules

Zack Mitchell (Core)

A presentation and demonstration showcasing how the Clinical Experience Lottery module can be used to populate rotation schedules based on learner preferences.

Testing Process for the Elentra Platform

Graham Berry (Core)

How to create Codeception Functional/Acceptance/Unit tests.

Automating Recruitment of Faculty for Structured Teaching through Elentra

Mike Paget (Cumming School of Medicine - U Calgary)

We've discovered one of our heaviest administrative

processes is recruitment.

Concurrently—we've been thinking about how to balance pre-clerkship exposure across R1 disciplines. Thanks to the infrastructure of Elentra, we're able to dissect our historical exposure and consider some of the opportunities and biases that automating some aspects of recruitment will introduce. This session is an introduction to an Elentra based project that we plan on implementing that would allow faculty to self schedule into available teaching sessions based on payment eligibility, R1 discipline and previous student evaluation scores.

Elentra JS Facilitated Discussion

Matt Simpson & Zack Mitchell (Core)

We're here to introduce Elentra JS 2.0, talk about the why, and the how.

How to leverage Elentra's assessment plan builder to support resident development and track performance in CBME

Andrew Dos-Santos and Mary Bouchard (Queen's University)

How to leverage Elentra's assessment plan builder to support resident development and track performance in CBME.

Registration

🕒 8:30 – 9:00

Elentra Engage Welcome

👤 Matt Simpson & Andrew Dos-Santos (Queen's University)

🕒 9:00 – 9:15 📍 Main Floor

Elentra Platform: A Year in Review, and a Look Ahead

👤 Matt Simpson (Elentra Consortium, Queen's University)

🕒 9:15 – 10:00 📍 Main Floor

Elentra Implementation Demo #1

🏛️ Northern Ontario School of Medicine

🕒 10:00 – 10:20 📍 Main Floor

Nutrition Break

🕒 10:20 – 10:40

UI Design: From Idea to Picture

👤 Samuel Hudson Campbell (Elentra Consortium, Queen's University)

🕒 10:40 – 11:20 📍 Main Floor

Elentra Implementation Demo #2

🏛️ University of Toronto

🕒 11:20 – 11:40 📍 Main Floor

Elentra Implementation Demo #3

🏛️ Kaiser Permanente

🕒 11:40 – 12:00 📍 Main Floor

Lunch

🕒 12:00 – 1:00

Enterprise Application Architecture in Elentra

👤 Eric Green (Elentra Consortium, Queen's University)

🕒 1:00 – 2:30 📍 Underground ●

How to Help Faculty Leaders Be Ready for CBME

👤 Susan Glover Takahashi (University of Toronto)

🕒 1:00 – 2:30 📍 Main Floor ●

Nutrition Break

🕒 2:30 – 2:50

Elentra Implementation Demo #4

🏛️ Queen's University

🕒 2:50 – 3:10 📍 Main Floor

Scheduling a Longitudinal Integrated Clerkship: A 100-day Post Mortem

👤 Sean Girard (Washington State University)

🕒 3:10 – 3:40 📍 Main Floor

Hackathon Presentations

🕒 3:40 – 4:35 📍 Main Floor

Closing Remarks

🕒 4:35 – 4:45 📍 Main Floor

Reception & Awards

🕒 4:45 – 6:20 📍 Main Floor

Dinner Reservations

🕒 6:30

Welcome Day 2

🕒 9:00 – 9:10

Elentra Implementation Demo #5

👤 University of British Columbia

🕒 9:10 – 9:30 📍 Main Floor

Elentra Implementation Demo #6

👤 To be announced

🕒 9:30 – 9:40 📍 Main Floor

UBC – An Agile Odyssey

👤 Stuart Rolland & Anthony Roggeveen
(University of British Columbia)

🕒 9:40 – 10:20 📍 Underground ●

Enhancing the Clinical Experience:
Leveraging the Lottery to Populate
Rotation Schedules

👤 Zack Mitchell (Elentra Consortium, Queen's University)

🕒 9:40 – 10:20 📍 Main Floor ●

Nutrition Break

🕒 10:20 – 10:40

Unconference Breakout Sessions

🕒 10:40 – 12:10

🗣️ **Technical Professionals Focus** – Facilitator: Matt Simpson

📍 Mezzanine

🗣️ **Undergraduate Medicine Focus** – Facilitator: Candace Miller

📍 Underground

🗣️ **Postgraduate/Graduate Medicine Focus** – Facilitator: Alison Pattern

📍 Main Floor 1

🗣️ **Family Medicine Focus** – Facilitator: Laura McEwen

📍 Main Floor 2

Lunch

🕒 12:10 – 1:10

Testing Process for the
Elentra Platform

👤 Graham Berry (Elentra Consortium, Queen's University)

🕒 1:10 – 2:00 📍 Underground ●

Automating Recruitment of
Faculty for Structured Teaching

👤 Mike Paget (Cumming School of Medicine, U Calgary)

🕒 1:10 – 2:00 📍 Main Floor ●

Elentra JS Facilitated Discussion

👤 Matt Simpson (Elentra Consortium, Queen's University)

🕒 2:00 – 2:35 📍 Underground ●

Using the Assessment Plan Builder
to Support Resident Development
and Track Performance in CBME👤 Andrew Dos-Santos & Mary Bouchard
(Queen's University)

🕒 2:00 – 2:35 📍 Main Floor ●

Nutrition Break

🕒 2:35 – 2:50

Closing Keynote – Adaptive Learning

👤 Dr. Martin V. Pusic, MD, PhD, FRCP(C)

Director, Division of Learning Analytics, Institute for Innovation in Medical Education, NYU School of Medicine

Associate Professor of Emergency Medicine, Department of Emergency Medicine, NYU School of Medicine

🕒 2:50 – 3:50 📍 Main Floor

Summary and Closing Remarks:
Elentra Consortium and Elentra Cloud Working Together
to Move Elentra Forward

👤 Matt Simpson and Andrew Dos-Santos

🕒 3:50 – 4:30 📍 Main Floor

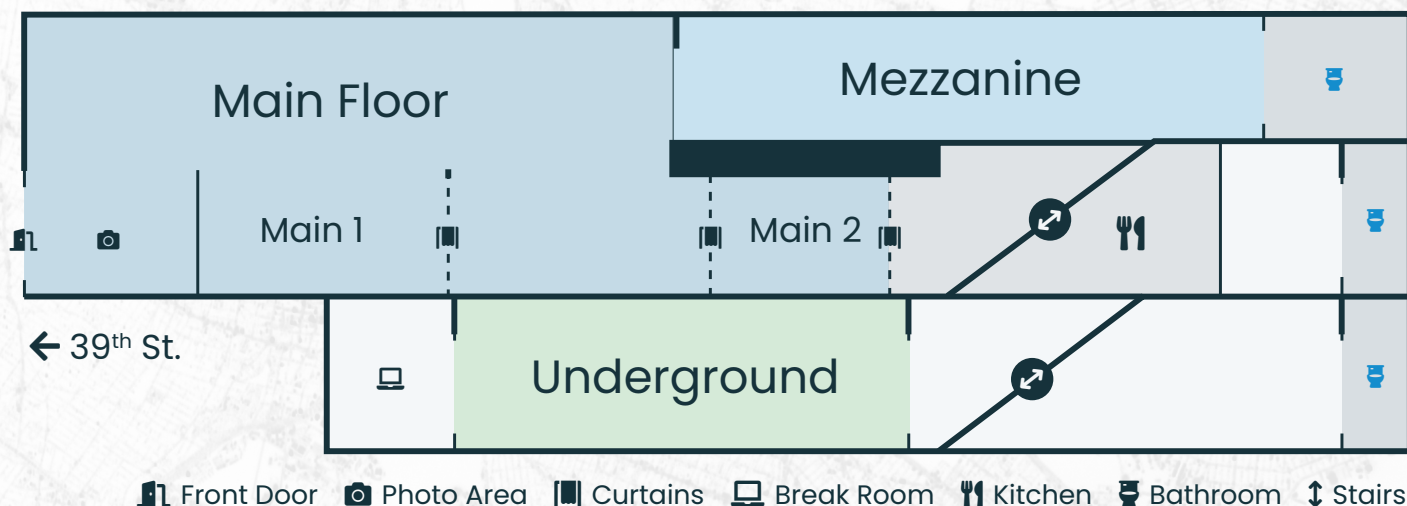

Want to share your thoughts or discuss a presentation? Log into collaborate.elentra.org

Every presentation and workshop has a discussion group located in Collaborate. Slides and resources will be hosted in the Elentra Engage Community after the Conference.



Get to know your fellow conference goers, the following people have consented to share their contact information among conference attendee's and look forward to hearing from you!

Alex Lopez
University of Arizona

Alexandre St-Amant
Northern Ontario School of Medicine
✉ astamant@nosm.ca

Alison Pattern
University of Toronto
✉ alison.pattern@utoronto.ca
🐦 @allypattern

Amy Koenigs knecht
Kaiser Permanente
✉ amy.x.koenigs knecht@kp.org

Anthony Roggeveen
University of British Columbia
✉ anthony.roggeveen@ubc.ca

Ben Smith Lea
University of Toronto

Bill Fleming
Rush University
✉ Bill_P_Fleming@rush.edu

Bob Webster
Rush University
✉ bob_webster@rush.edu

Caroline Abrahams
University of Toronto
✉ caroline.abrahams@utoronto.ca

Christina Graves
Northern Ontario School of Medicine
✉ cgraves@nosm.ca

Christopher Jones
University of Toronto

Dani Dilkes
Western University
✉ ddilkes2@uwo.ca

Devin Wong
National University of Singapore
✉ medwwhd@nus.edu.sg

Doug Hall
University of Calgary
✉ hall@ucalgary.ca
🐦 @dlhall

Dr. Carolyn Dufault
Washington University in St. Louis
✉ cdufault@wustl.edu

Dr. Christopher Faulkner
University of Texas Southwestern
✉ christopher.faulkner@utsouthwestern.edu

Dr. Emily Thompson
Washington University in St. Louis
✉ emilywthompson@wustl.edu
🐦 @DrEmilyT

Dr. Gerald Thrush
Western University
✉ gthrush@westernu.edu

Dr. Jeffrey Davis
University of Arizona

Dr. Jennifer Cuthbert
University of Texas Southwestern
✉ jennifer.cuthbert@utsouthwestern.edu

Dr. Laura McEwen
Queen's University
✉ laura.mcewen@queensu.ca

Dr. Patricia Camberos
Western University
✉ pcamberos@westernu.edu

Dr. Santiago Toro Posada
Washington State University
✉ donna.kimball@wsu.edu

Dr. Sharon Dial
University of Arizona
✉ sdial@email.arizona.edu

Dr. Yulia Pillar
University of Texas Southwestern

Eleni Tsakumis
University of British Columbia
✉ eleni.tsakumis@ubc.ca

Elliott Freid
Rush University

Eric Green
Core Team
✉ eg74@queensu.ca

Eric Larouche
University of Ottawa
✉ Elarouch@uottawa.ca

Fermin Martinez Fregoso
University of Arizona

Jason Crustals
Washington University in St. Louis
✉ crustalsj@wustl.edu

Jeff Bachiu
Northern Ontario School of Medicine
✉ jbachiu@nosm.ca

Jeffrey Fung
University of British Columbia
✉ jeffrey.fung@ubc.ca

Jon-Paul Marchand
University of British Columbia
✉ jmarchan@mail.ubc.ca

Julie Rendell
Northern Ontario School of Medicine
✉ jrendell@nosm.ca

Karl Oder
Rush University
✉ koder@rush.edu

Kate Campbell
University of British Columbia
✉ kate.c@ubc.ca

Ke Zhong
University of Manitoba
✉ ke.zhong@umanitoba.ca

Kraig Meville
University of Calgary
✉ kmeville@ucalgary.ca

Lara McMahon
Western University
✉ lmcMahon@westernu.edu

Laura McDiarmid
Queen's University
✉ lml23@queensu.ca
🐦 @McDiarmid_Laura

Lynette Terrill
University of Toronto
✉ lynette.terryll@utoronto.ca

Marisa Orser
Western University

Mary Bouchard
Queen's University
✉ mary.bouchard@queensu.ca
🐦 @MarBouchard

Matt Simpson
Core Team
✉ simpson@queensu.ca
🐦 @m_simpson

Max Cartwright
Wright State University
✉ max.cartwright@wright.edu

Michael Fariborz
Washington University in St. Louis

Michael Martyn
Northern Ontario School of Medicine
✉ mmartyn@nosm.ca

Mike Paget
University of Calgary
✉ mkpaget@ucalgary.ca
🐦 @gobstopperx

Nathan Watson
Kaiser Permanente
✉ nathan.a.watson@kp.org

Nicole Bessette
Northern Ontario School of Medicine
✉ nbessette@nosm.ca

Norman Hopson
University of Southern California
✉ hopson@usc.edu

Odile Kaufmann
University of Ottawa
✉ okaufma2@uottawa.ca

Penny Nanayakkara
University of Manitoba
✉ penny.nanayakkara@umanitoba.ca

Phillip Chung
University of Toronto
✉ philip.chung@utoronto.ca

Sadiq Mohamed
Weill Cornell Medicine - Qatar

Sam Chan
University of Toronto

Sam Payne
UCLA
✉ spayne@mednet.ucla.edu

Samuel Campbell
Core Team
✉ shc6@queensu.ca
🐦 @shc_design_thinking

Sean Girard
Washington State University
✉ sean.girard@wsu.edu

Shalom Quek
National University of Singapore
✉ medsqx1@nus.edu.sg

Stuart Rolland
University of British Columbia

Sylvia Lim
University of British Columbia
✉ sylvia.lim@ubc.ca

Thaisa Ramos de Almeida
National University of Singapore
✉ medtrda@nus.edu.sg

Tyronza Herring
Western University

Zack Mitchell
Core Team
✉ zcgm@queensu.ca

